

GROUP 80A

CONFIGURATION DIAGRAMS

CONTENTS

OVERALL CONFIGURATION DIAGRAM.....	80A-2	ENGINE AND TRANSAXLE <2.4L ENGINE>	80A-10
HOW TO READ CONFIGURATION DIAGRAMS	80A-3	DASH PANEL.....	80A-14
ENGINE COMPARTMENT.....	80A-4	FLOOR AND ROOF	80A-20
ENGINE AND TRANSAXLE <2.0L ENGINE>	80A-6	DOOR	80A-22
		LUGGAGE COMPARTMENT.....	80A-24

OVERALL CONFIGURATION DIAGRAM

M1801000100622

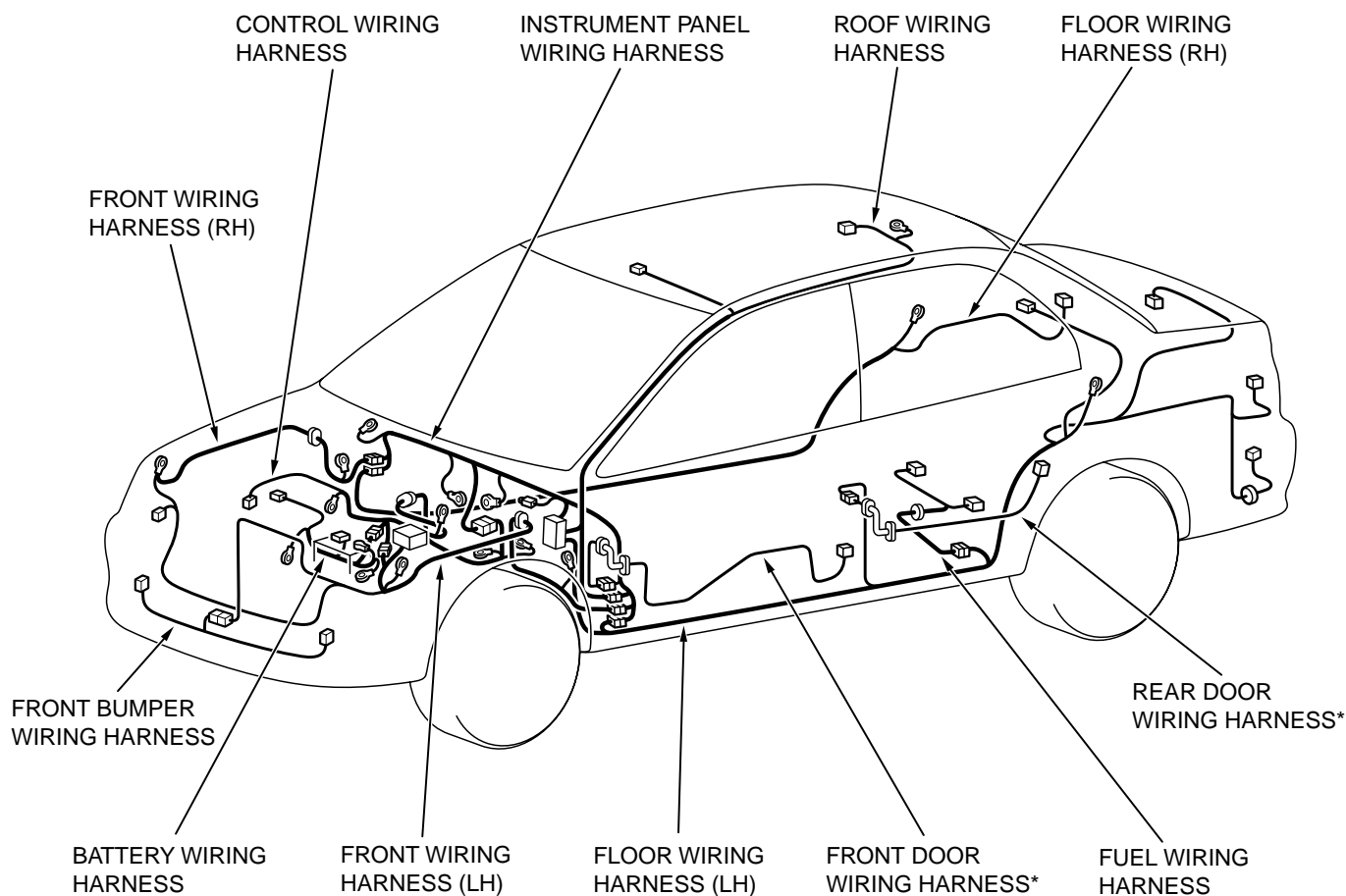

NOTE:

1. THIS ILLUSTRATION SHOWS ONLY MAJOR WIRING HARNESSES.
2. *: ALSO EQUIPPED AT THE RIGHT SIDE.

HOW TO READ CONFIGURATION DIAGRAMS

M1801000200351

The wiring harness diagrams clearly show the connector locations and harness routings at each site on actual vehicles.

Denotes connector No.

The same connector No. is used throughout the circuit diagrams to facilitate connector location searches.

The first alphabetical symbol indicates the location site of the connector and a number that follows is the unique number. Numbers are usually assigned to parts in clockwise order on the diagram.

Example: A-19

- Number specific to connector (serial number)
- Connector location site symbol
- A: ENGINE COMPARTMENT
- B: ENGINE AND TRANSAXLE
- C: DASH PANEL
- D: FLOOR AND ROOF
- E: DOOR
- F: LUGGAGE COMPARTMENT

Denotes ground point.

Same ground number is used throughout circuit diagrams to facilitate search of ground point. Refer to GROUP 70 SINGLE PART INSTALLATION POSITION - GROUND MOUNTING LOCATIONS for details of ground points.

Denotes harness name.

Denotes a section covered by a corrugated tube.

The mark ★ shows the standard mounting position of wiring harness.

Denotes the color of the tube.
(If not specified, it is black.)
R: Red
Y: Yellow

The number of connector pins and the connector color (except milk white)* are shown for ease of retrieval.

Example: (2-B)

- Connector color
(milk white if no color is indicated)
- Number of connector pins

*: Typical connector colors

- | | |
|-----------|------------------|
| B: Black | BR: Brown |
| Y: Yellow | V: Violet |
| L: Blue | O: Orange |
| G: Green | GR: Gray |
| R: Red | NONE: Milk white |

A-19

FRONT
WIRING
HARNESS
(RH)

A-18

A-17

A-16

A-15

- A-15 (2)
- A-16 (2-GR)
- A-17 (2-B)
- A-18 (2-B)
- A-19 (2-GR)
- FOG LIGHT (RH)
- HORN (LOW)
- HEADLIGHT (RH)
- WINDSHIELD WASHER MOTOR
- DUAL PRESSURE SWITCH

Indicates the device to which the connector is connected.

AC003056AH

ENGINE COMPARTMENT

M1801000300842

Connector
symbol**A**CONNECTOR COLOR
CODE

B : BLACK
 BR : BROWN
 G : GREEN
 GR : GRAY
 L : BLUE
 NONE : MILK WHITE
 O : ORANGE
 R : RED
 V : VIOLET
 Y : YELLOW

A-01	(2-GR)	SIDE TURN SIGNAL LIGHT (RH)
A-02	(2-GR)	SIDE TURN SIGNAL LIGHT (LH)
A-03	(2-B)	WHEEL SPEED SENSOR (FRONT: LH) <ABS>
A-04X	(4)	FOG LIGHT RELAY
A-05X	(4)	HORN RELAY
A-09X	(4)	FAN CONTROL RELAY
A-10X	(11)	FRONT-ECU
A-11X	(11)	FRONT-ECU

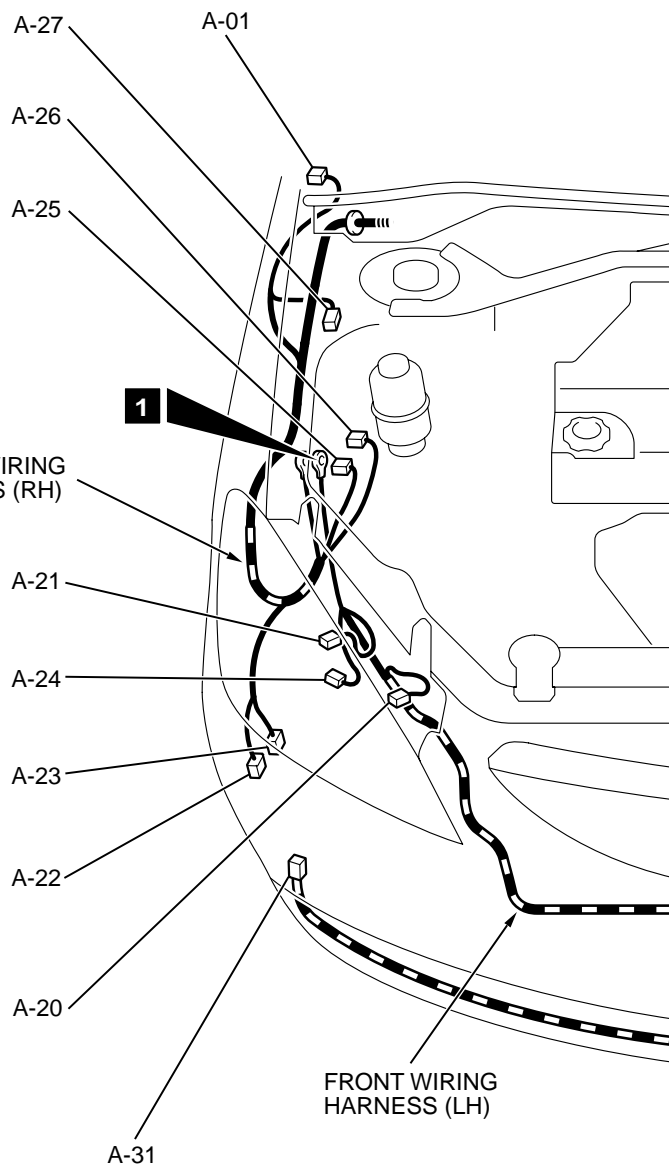

AC306147AB

A-12	(2-B)	FRONT WIRING HARNESS (LH) AND CONTROL WIRING HARNESS COMBINATION <ABS>
A-13	(12-B)	FRONT WIRING HARNESS (LH) AND CONTROL WIRING HARNESS COMBINATION
A-14	(2-B)	POSITION LIGHT (LH)
A-15	(3-B)	HEADLIGHT (LH)
A-16	(2)	FRONT TURN SIGNAL LIGHT (LH)

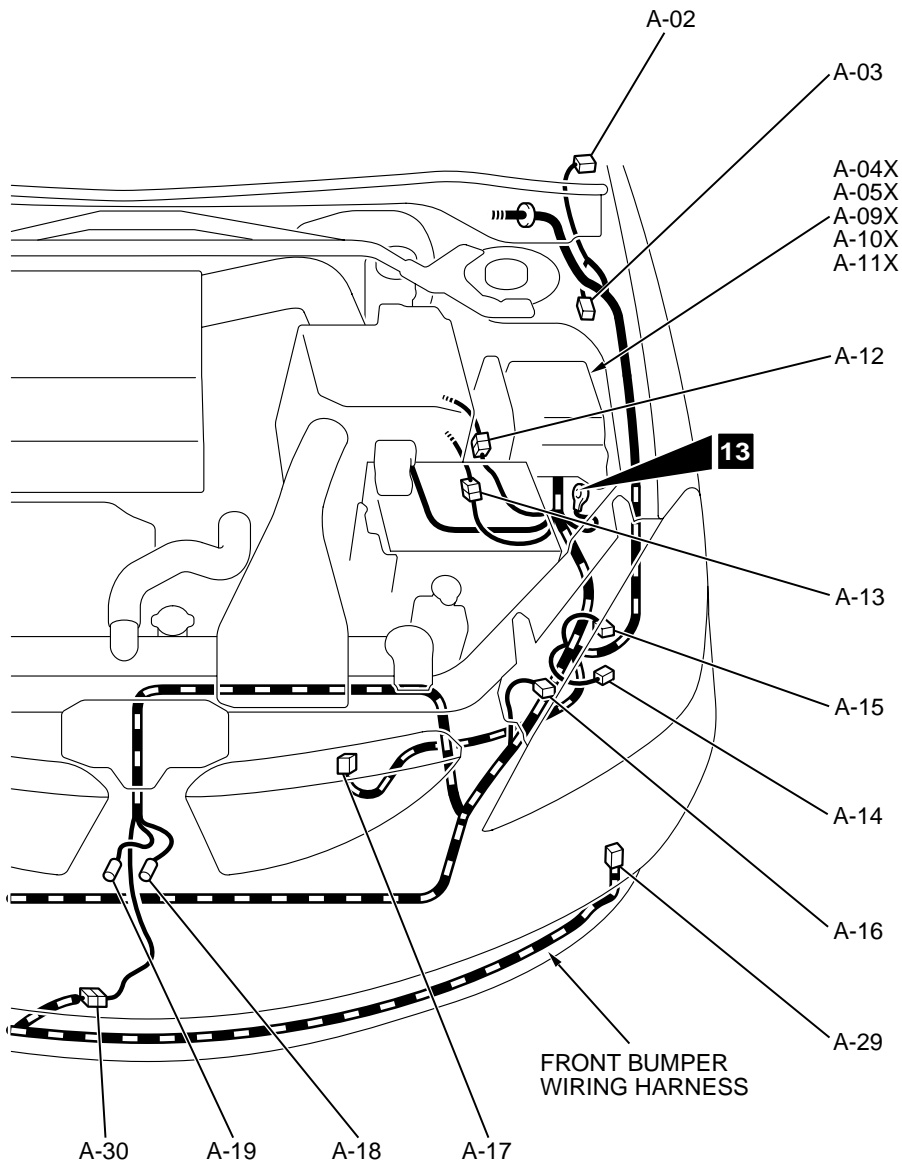

AC306148AB

A-17	(3-GR)	FAN CONTROL MODULE	A-26	(4-B)	AUTO-CRUISE CONTROL VACUUM PUMP
A-18	(1-B)	HORN (HIGH)	A-27	(2-B)	WHEEL SPEED SENSOR (FRONT: RH) <ABS>
A-19	(1-B)	HORN (LOW)	A-29	(2-B)	FOG LIGHT (LH)
A-20	(2)	FRONT TURN SIGNAL LIGHT (RH)	A-30	(2-B)	FRONT WIRING HARNESS (LH) AND FRONT BUMPER WIRING HARNESS COMBINATION
A-21	(3-B)	HEADLIGHT (RH)	A-31	(2-B)	FOG LIGHT (RH)
A-22	(2)	WINDSHIELD WASHER MOTOR			
A-23	(2-G)	REAR WASHER MOTOR			
A-24	(2-B)	POSITION LIGHT (RH)			
A-25	(2-BR)	DUAL PRESSURE SWITCH			

ENGINE AND TRANSAXLE <2.0L ENGINE>

M1801000400731

Connector
symbol**B** -01
thru
-25CONNECTOR COLOR
CODE

B : BLACK
 BR : BROWN
 G : GREEN
 GR : GRAY
 L : BLUE
 NONE : MILK WHITE
 O : ORANGE
 R : RED
 V : VIOLET
 Y : YELLOW

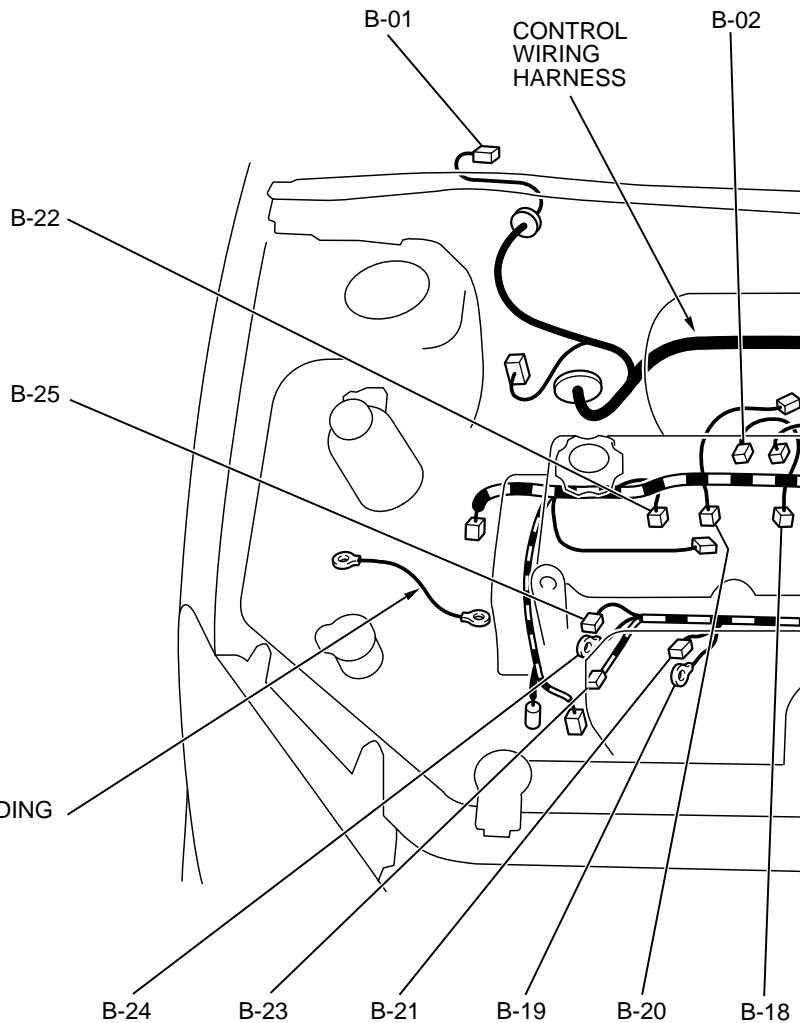
GROUNDING
CABLE

AC306150AB

B-01	(5-GR)	WINDSHIELD WIPER MOTOR
B-02	(2-B)	EVAPORATIVE EMISSION PURGE SOLENOID VALVE
B-03	(3-GR)	THROTTLE POSITION SENSOR
B-04	(3-B)	VEHICLE SPEED SENSOR <M/T>
B-05	(2-GR)	BRAKE FLUID LEVEL INDICATOR SWITCH
B-06X	(1)	ENGINE SPEED DETECTION CONNECTOR
B-07X	(5)	STARTER RELAY <M/T>

B-11X	(4)	A/T CONTROL RELAY
B-12X	(4)	MFI RELAY
B-13X	(4)	A/C COMPRESSOR CLUTCH RELAY
B-14	(6-B)	CONTROL WIRING HARNESS AND BATTERY WIRING HARNESS COMBINATION
B-15	(10-GR)	A/T CONTROL SOLENOID VALVE ASSEMBLY

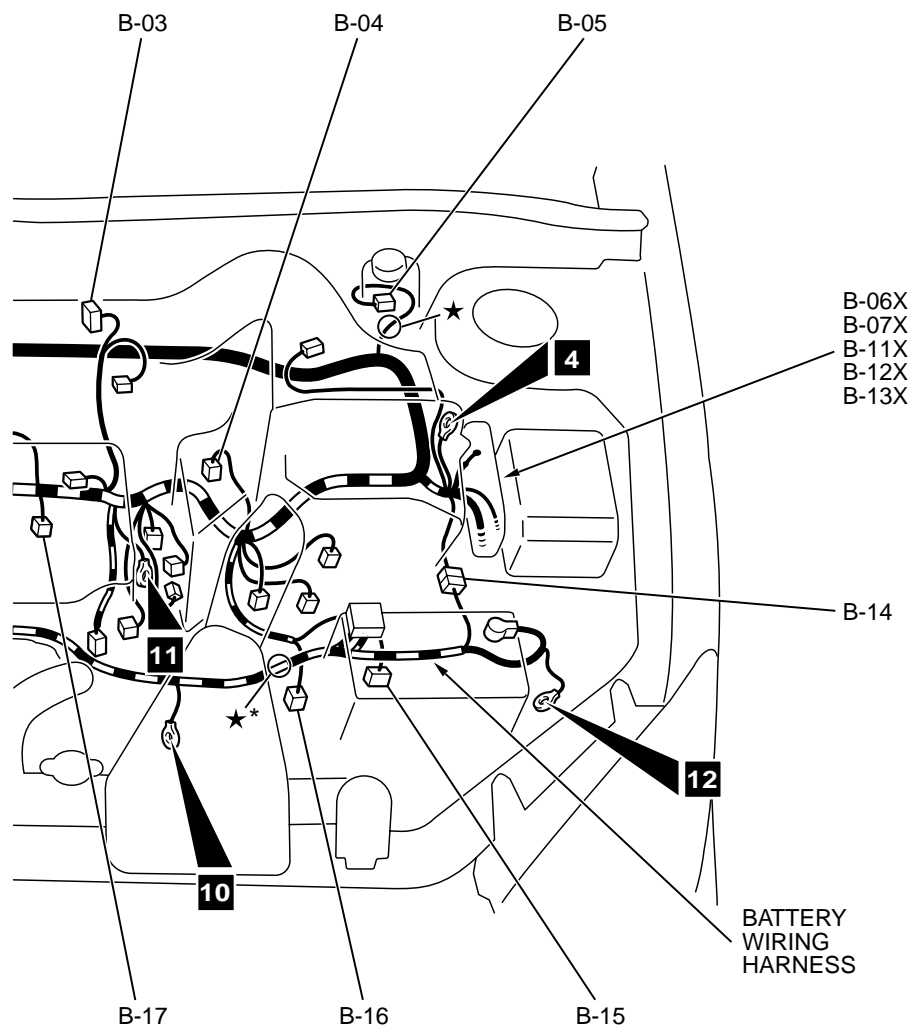

AC306151AB

B-16	(10-B)	TRANSMISSION RANGE SWITCH <A/T>
B-17	(2-GR)	INJECTOR 4
B-18	(2-GR)	INJECTOR 3
B-19	(1)	STARTER
B-20	(2-GR)	INJECTOR 2
B-21	(1-B)	STARTER
B-22	(2-GR)	INJECTOR 1
B-23	(1-B)	ENGINE OIL PRESSURE SWITCH

B-24	(1)	GENERATOR
B-25	(4-GR)	GENERATOR

NOTE:

- ON A/T ONLY, THE STANDARD MOUNTING POSITION OF WIRING HARNESS IS MARKED BY *.

ENGINE AND TRANSAXLE <2.0L ENGINE> (CONTINUED)

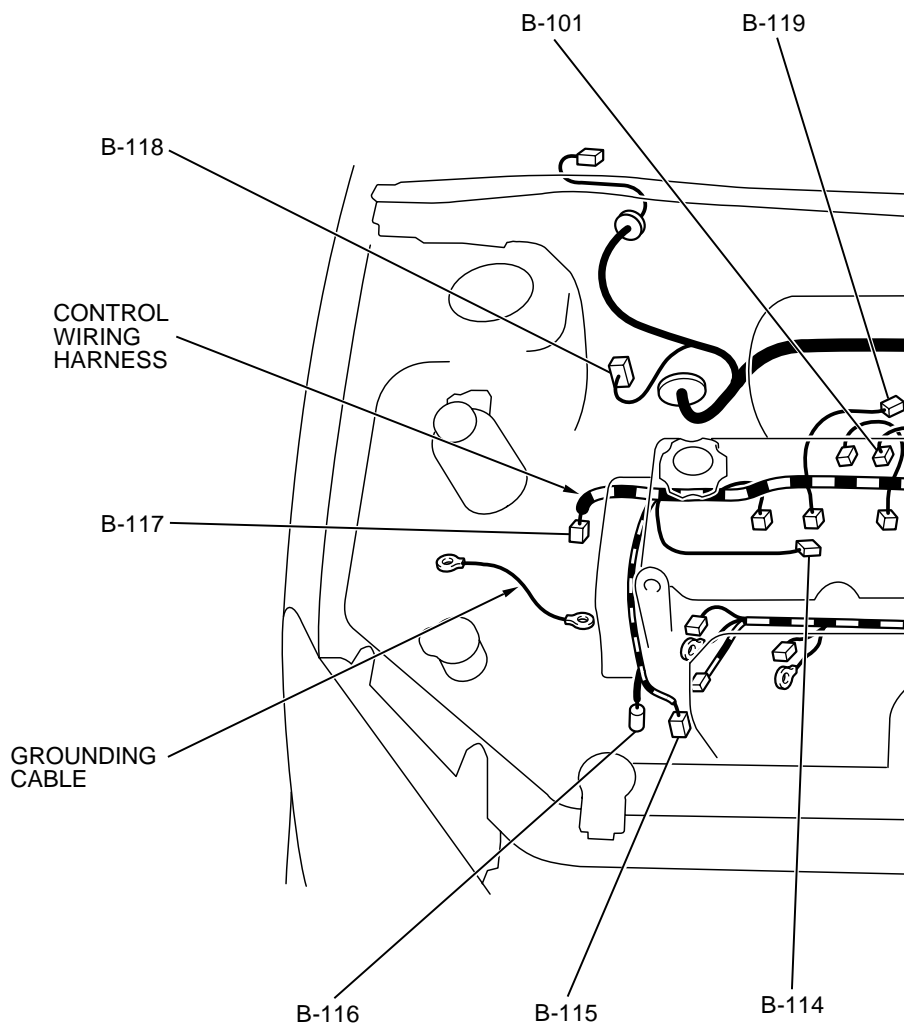
Connector
symbol**B** -101
thru
-119CONNECTOR COLOR
CODE

B : BLACK
 BR : BROWN
 G : GREEN
 GR : GRAY
 L : BLUE
 NONE : MILK WHITE
 O : ORANGE
 R : RED
 V : VIOLET
 Y : YELLOW

AC306150AC

B-101 (2-BR) EGR SOLENOID VALVE
 B-103 (3-GR) IGNITION COIL 1
 B-104 (6-B) IDLE AIR CONTROL MOTOR
 B-105 (7-B) VOLUME AIR FLOW SENSOR
 B-106 (3-B) CAMSHAFT POSITION SENSOR
 B-107 (2-B) ENGINE COOLANT TEMPERATURE
 SENSOR
 B-108 (2-GR) KNOCK SENSOR

B-109 (3-GR) OUTPUT SHAFT SPEED SENSOR
 <A/T>
 B-110 (3-B) INPUT SHAFT SPEED SENSOR
 <A/T>
 B-111 (2-B) BACKUP LIGHT SWITCH <M/T>
 B-112 (1-B) ENGINE COOLANT TEMPERATURE
 GAUGE UNIT

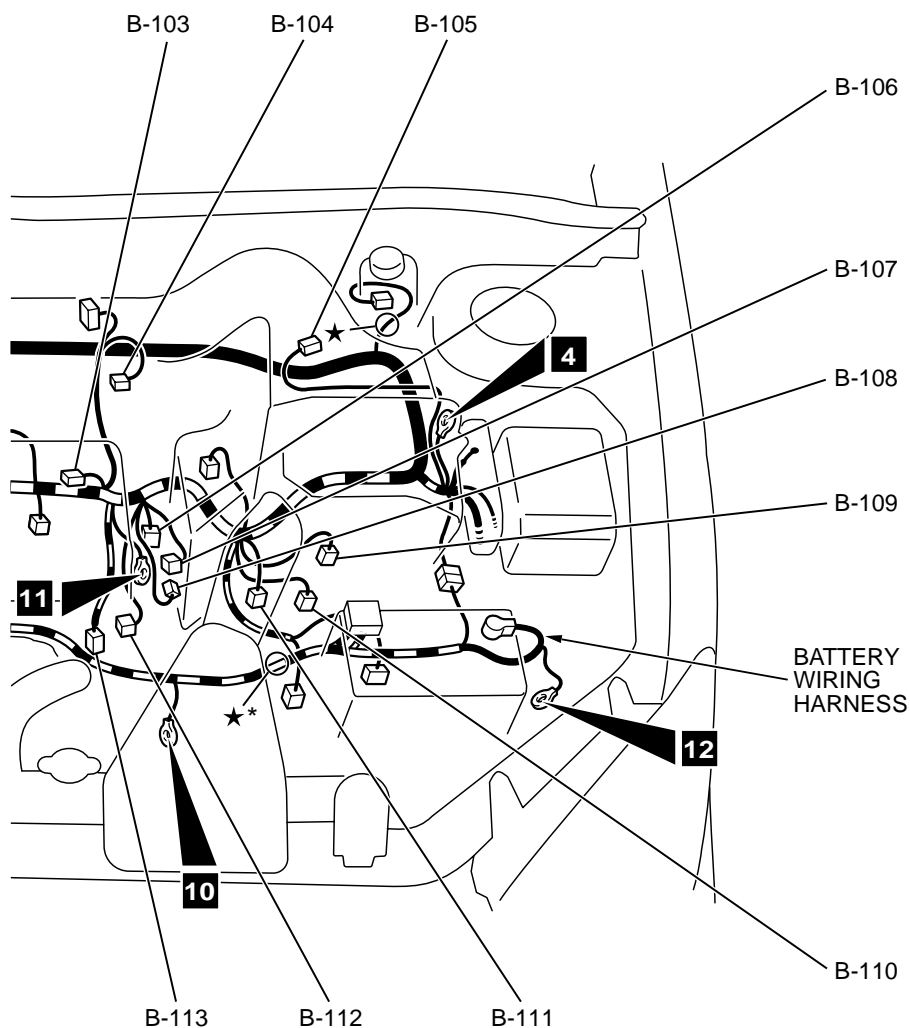

AC306151AC

- B-113 (4-B) HEATED OXYGEN SENSOR (FRONT)
 B-114 (3-GR) IGNITION COIL 2
 B-115 (1-B) A/C COMPRESSOR ASSEMBLY
 B-116 (1-B) POWER STEERING PRESSURE SWITCH
 B-117 (3-GR) CRANKSHAFT POSITION SENSOR
 B-118 (28-GR) ABS-ECU

- B-119 (3-B) MANIFOLD ABSOLUTE PRESSURE SENSOR

NOTE:

- ON A/T ONLY, THE STANDARD MOUNTING POSITION OF WIRING HARNESS IS MARKED BY *.

ENGINE AND TRANSAXLE <2.4L ENGINE>

M1801000400797

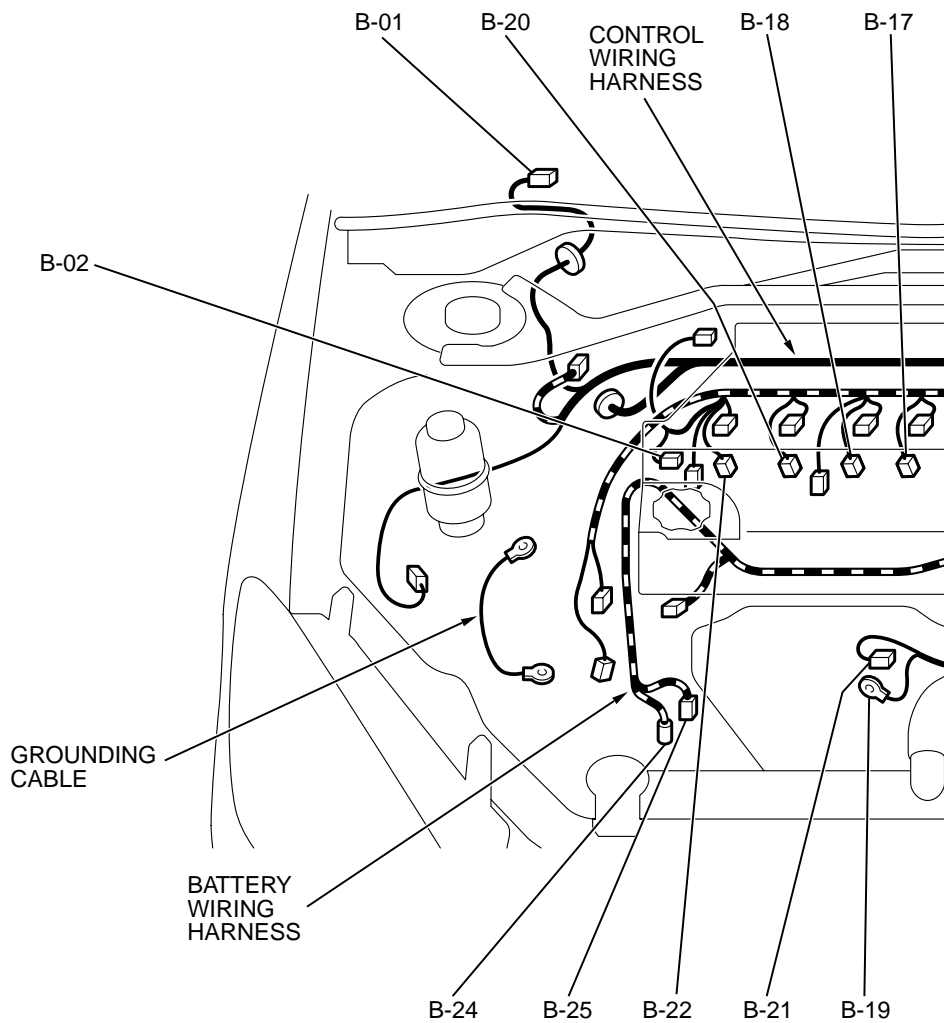
Connector
symbol**B** -01
thru
-25CONNECTOR COLOR
CODE

B: BLACK
 BR: BROWN
 G: GREEN
 GR: GRAY
 L: BLUE
 NONE: MILK WHITE
 O: ORANGE
 R: RED
 V: VIOLET
 Y: YELLOW

AC306144AB

B-01	(5-GR)	WINDSHIELD WIPER MOTOR
B-02	(2-B)	EVAPORATIVE EMISSION PURGE SOLENOID VALVE
B-03	(6-B)	THROTTLE POSITION SENSOR
B-04	(3-B)	VEHICLE SPEED SENSOR <M/T>
B-05	(2-GR)	BRAKE FLUID LEVEL INDICATOR SWITCH
B-06X	(1)	ENGINE SPEED DETECTION CONNECTOR
B-07X	(5)	STARTER RELAY <M/T>

B-09X	(4)	THROTTLE ACTUATOR CONTROL MOTOR RELAY
B-11X	(4)	A/T CONTROL RELAY
B-12X	(4)	MFI RELAY
B-13X	(4)	A/C COMPRESSOR CLUTCH RELAY
B-14	(8-B)	CONTROL WIRING HARNESS AND BATTERY WIRING HARNESS COMBINATION

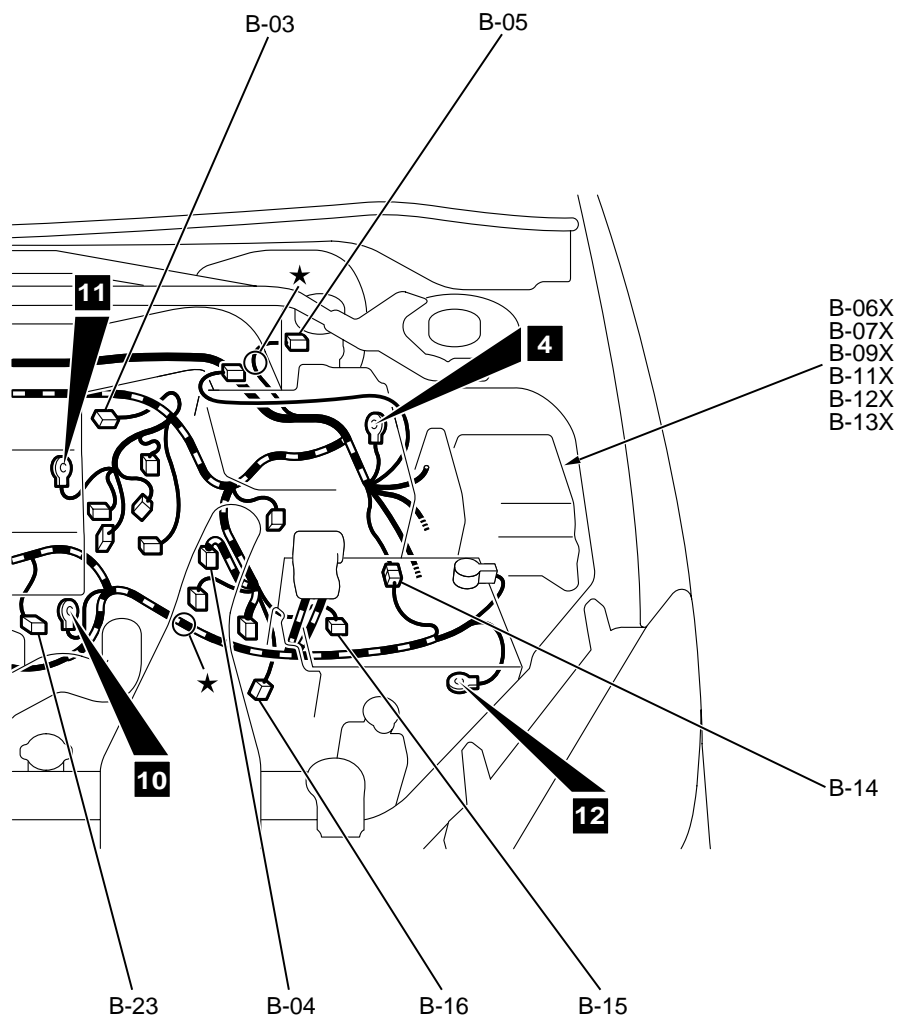

AC306145AB

B-15 (10-GR) A/T CONTROL SOLENOID VALVE
ASSEMBLY
B-16 (10-B) TRANSMISSION RANGE SWITCH
<A/T>
B-17 (2-GR) INJECTOR 4
B-18 (2-GR) INJECTOR 3
B-19 (1) STARTER

B-20 (2-GR) INJECTOR 2
B-21 (1-B) STARTER
B-22 (2-GR) INJECTOR 1
B-23 (1-B) ENGINE OIL PRESSURE SWITCH
B-24 (1) GENERATOR
B-25 (4-GR) GENERATOR

ENGINE AND TRANSAXLE <2.4L ENGINE> (CONTINUED)

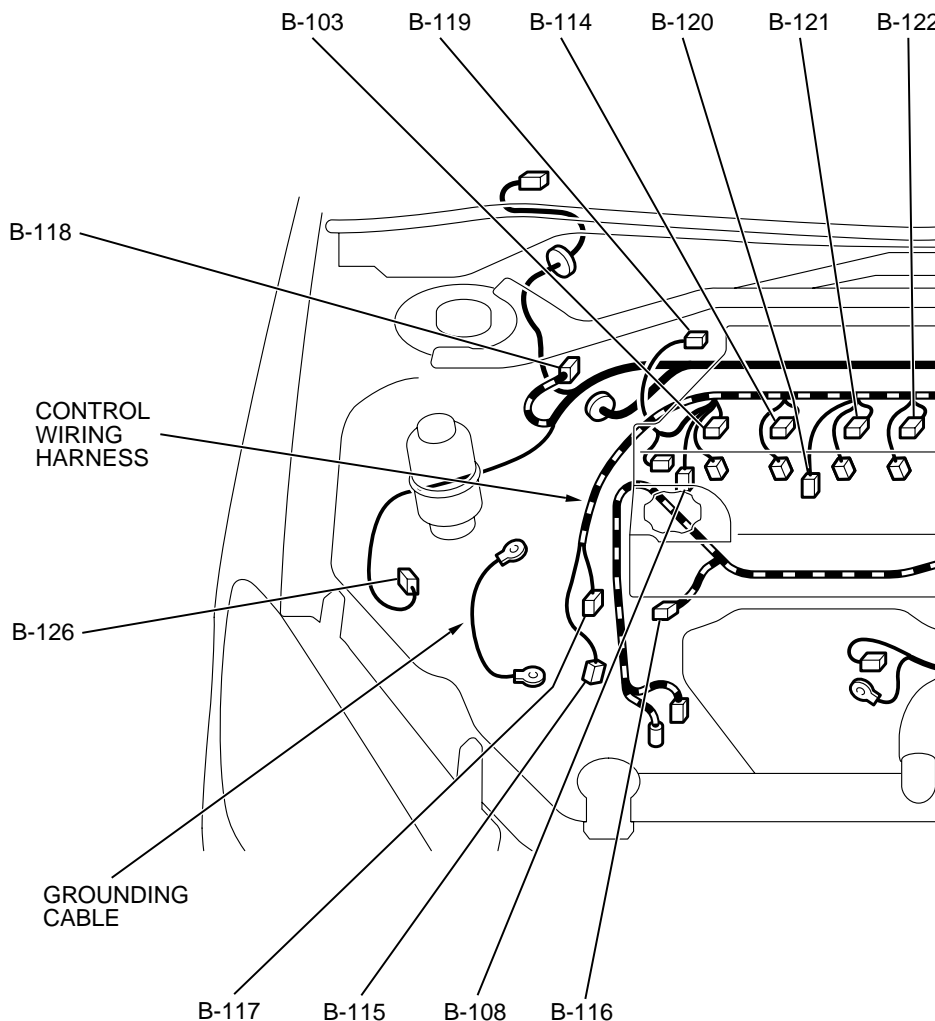
Connector
symbol**B** -103
thru
-126CONNECTOR COLOR
CODE

B: BLACK
 BR: BROWN
 G: GREEN
 GR: GRAY
 L: BLUE
 NONE: MILK WHITE
 O: ORANGE
 R: RED
 V: VIOLET
 Y: YELLOW

AC306144AC

B-103 (3-GR) IGNITION COIL 1
 B-106 (3-B) CAMSHAFT POSITION SENSOR
 B-107 (2-B) ENGINE COOLANT TEMPERATURE
 SENSOR
 B-108 (2-GR) KNOCK SENSOR
 B-109 (3-GR) OUTPUT SHAFT SPEED SENSOR
 <A/T>
 B-110 (3-B) INPUT SHAFT SPEED SENSOR
 <A/T>

B-111 (2-B) BACKUP LIGHT SWITCH <M/T>
 B-112 (1-B) ENGINE COOLANT TEMPERATURE
 GAUGE UNIT
 B-114 (3-GR) IGNITION COIL 2
 B-115 (1-B) A/C COMPRESSOR ASSEMBLY
 B-116 (1-B) POWER STEERING PRESSURE
 SWITCH

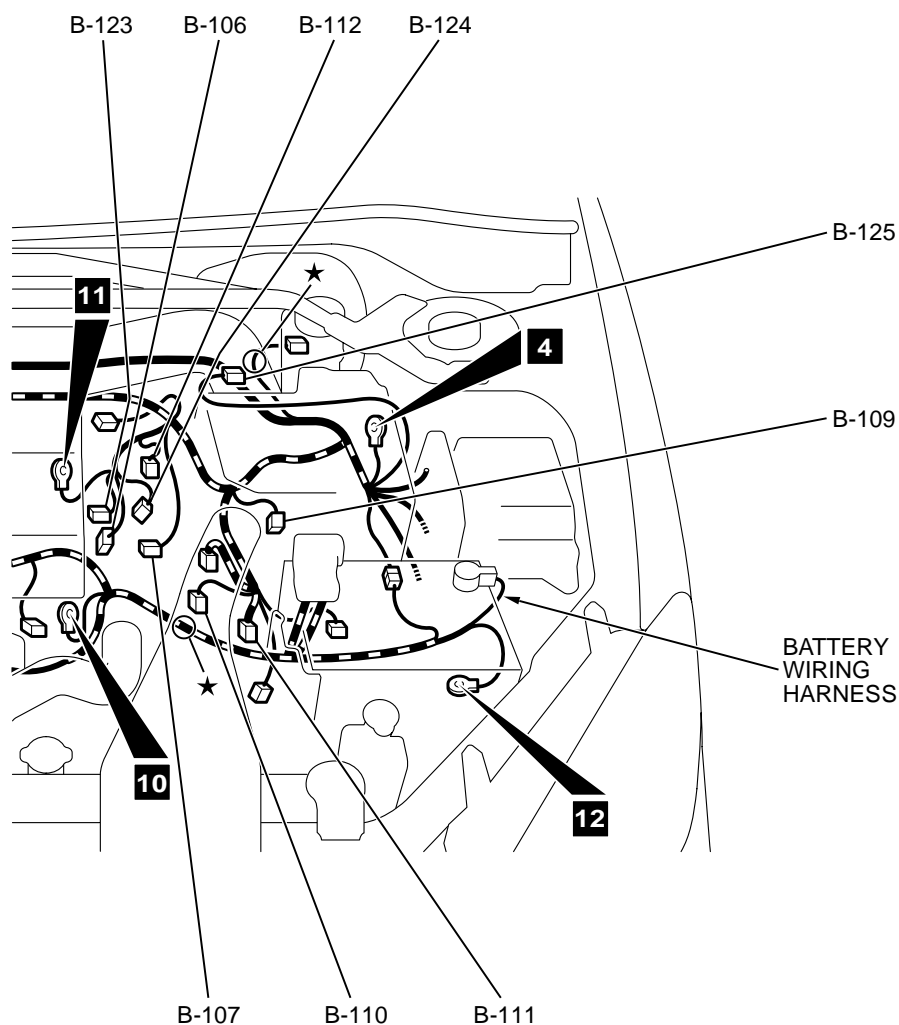

AC306145AC

B-117 (3-GR) CRANKSHAFT POSITION SENSOR
B-118 (28-GR) ABS-ECU
B-119 (3-B) MANIFOLD ABSOLUTE PRESSURE
SENSOR
B-120 (6-GR) EXHAUST GAS RECIRCULATION
VALVE
B-121 (3-GR) IGNITION COIL 3
B-122 (3-GR) IGNITION COIL 4

B-123 (1-B) ENGINE OIL PRESSURE SWITCH
(FOR ENGINE OIL CONTROL
VALVE)
B-124 (2-B) ENGINE OIL CONTROL VALVE
B-125 (4-GR) MASS AIR FLOW SENSOR
B-126 (8-GR) ACCELERATOR PEDAL POSITION
SENSOR

DASH PANEL

M1801000600713

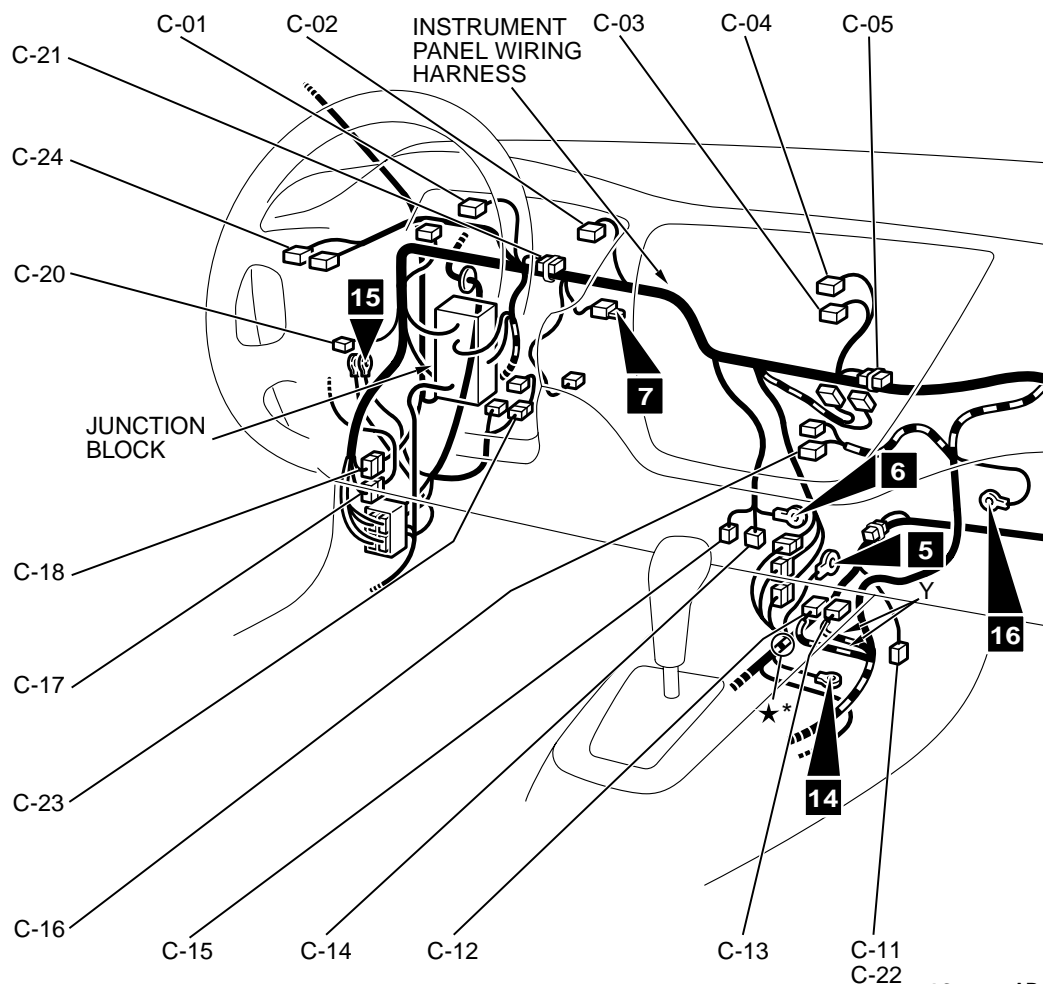
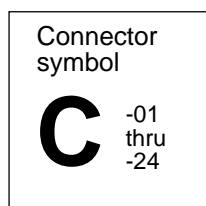

AC306141AB

C-01	(21)	COMBINATION METER	C-10	(7)	INSTRUMENT PANEL WIRING HARNESS AND A/C WIRING HARNESS COMBINATION
C-02	(21-L)	COMBINATION METER	C-11	(4)	HEATED OXYGEN SENSOR (REAR) <2.0L ENGINE>
C-03	(4)	HAZARD WARNING LIGHT SWITCH	C-12	(20-Y)	SRS-ECU
C-04	(4)	CLOCK	C-13	(22-Y)	SRS-ECU
C-05	(22-GR)	JOINT CONNECTOR (1)	C-14	(16-B)	DATA LINK CONNECTOR
C-06	(22-GR)	JOINT CONNECTOR (3)	C-15	(12)	DATA LINK CONNECTOR
C-07	(7)	OUTSIDE/INSIDE AIR SELECTION DAMPER CONTROL MOTOR			
C-08	(2)	BLOWER MOTOR			
C-09	(4)	RESISTOR			

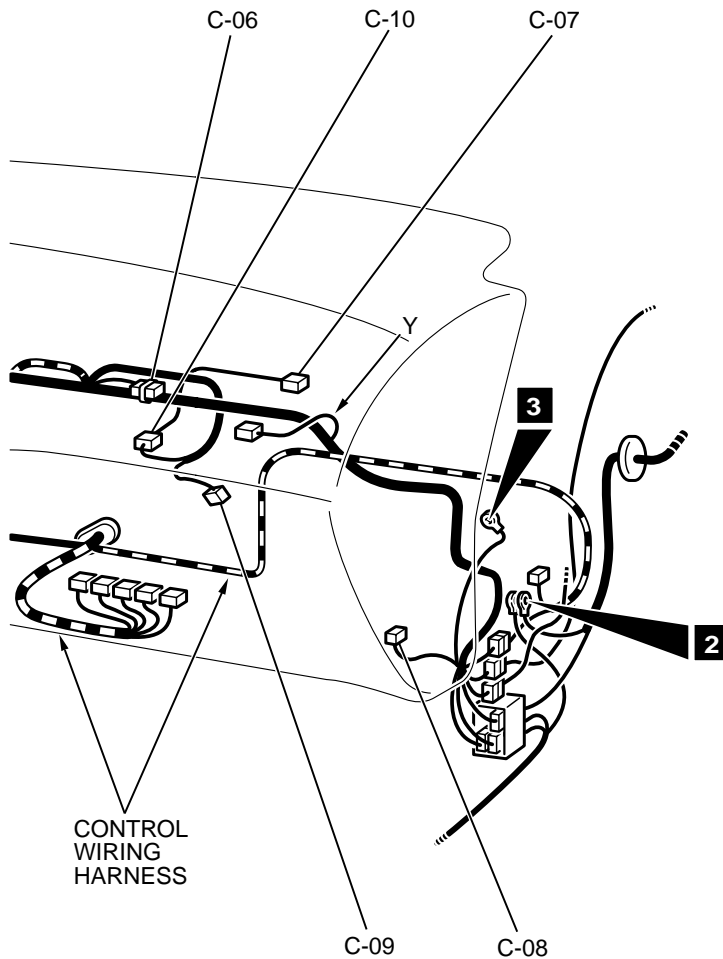

CONNECTOR COLOR
CODE
B : BLACK
BR : BROWN
G : GREEN
GR : GRAY
L : BLUE
NONE : MILK WHITE
O : ORANGE
R : RED
V : VIOLET
Y : YELLOW

AC306142AB

C-16	(16-B)	A/C-ECU <MANUAL A/C> OR HEATER CONTROL UNIT <HEATER>
C-17	(20)	INSTRUMENT PANEL WIRING HARNESS AND FRONT DOOR WIRING HARNESS (LH) COMBINATION
C-18	(6)	INSTRUMENT PANEL WIRING HARNESS AND SUNROOF WIRING HARNESS COMBINATION
C-20	(6-L)	RHEOSTAT
C-21	(22-B)	JOINT CONNECTOR (5)

C-22	(4)	HEATED OXYGEN SENSOR (FRONT) <2.4L ENGINE>
C-23	(2)	INSTRUMENT PANEL WIRING HARNESS AND CLUTCH SWITCH SUB WIRING HARNESS COMBINATION <M/T>
C-24	(6)	FOG LIGHT SWITCH

NOTE:

- ON 2.4L ENGINE ONLY, THE STANDARD MOUNTING POSITION OF WIRING HARNESS IS MARKED BY *.

DASH PANEL (CONTINUED)

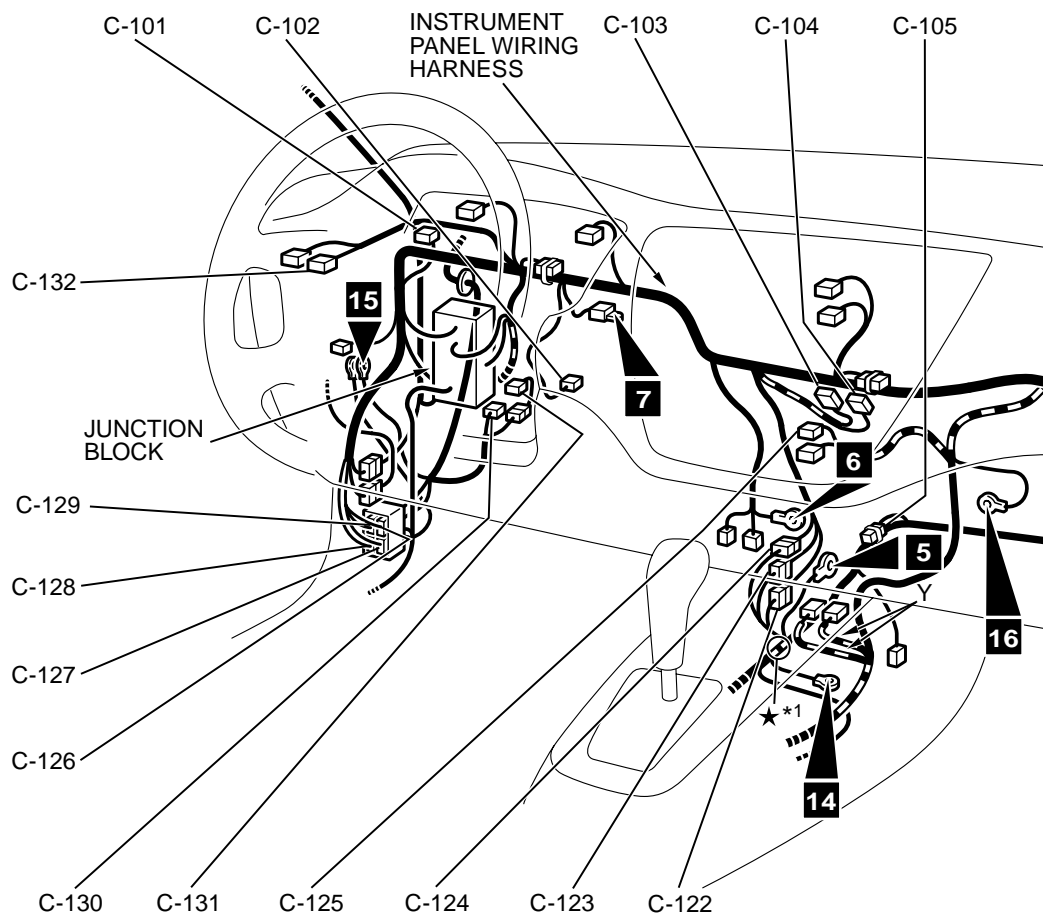
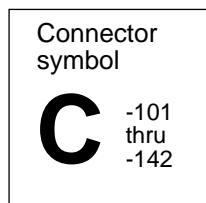

AC306141AC

C-101 (22-B)	JOINT CONNECTOR (2)	C-113 (13)	INSTRUMENT PANEL WIRING HARNESS AND FLOOR WIRING HARNESS (RH) COMBINATION
C-102 (4)	STOPLIGHT SWITCH	C-114 (30-GR)	POWERTRAIN CONTROL MODULE <2.0L ENGINE-A/T>
C-103 (14)	RADIO AND CD PLAYER	C-115 (22-Y)	ENGINE CONTROL MODULE <2.0L ENGINE-M/T>
C-104 (1)	GLASS ANTENNA	C-116 (28-GR)	POWERTRAIN CONTROL MODULE <2.0L ENGINE-A/T>
C-105 (33)	JOINT CONNECTOR (6)	C-117 (12-Y)	ENGINE CONTROL MODULE <2.0L ENGINE-M/T>
C-106 (2-R)	AIR BAG MODULE (SQUIB) <PASSENGER'S SIDE>	C-118 (26-GR)	POWERTRAIN CONTROL MODULE <2.0L ENGINE-A/T>
C-107 (16-B)	AUTO-CRUISE CONTROL-ECU <2.0L ENGINE>	C-119 (16-Y)	ENGINE CONTROL MODULE <2.0L ENGINE-M/T>
C-108 (11-L)	INSTRUMENT PANEL WIRING HARNESS AND CONTROL WIRING HARNESS COMBINATION	C-120 (35-GR)	POWERTRAIN CONTROL MODULE <2.0L ENGINE-A/T>
C-109 (2)	INSTRUMENT PANEL WIRING HARNESS AND TWEETER WIRING HARNESS COMBINATION	C-121 (26-Y)	ENGINE CONTROL MODULE <2.0L ENGINE-M/T>
C-110 (16)	INSTRUMENT PANEL WIRING HARNESS AND FRONT DOOR WIRING HARNESS (RH) COMBINATION	C-122 (22-L)	INSTRUMENT PANEL WIRING HARNESS AND CONTROL WIRING HARNESS COMBINATION
C-111 (25)	FRONT WIRING HARNESS (RH) AND INSTRUMENT PANEL WIRING HARNESS COMBINATION	C-123 (10-GR)	INSTRUMENT PANEL WIRING HARNESS AND CONTROL WIRING HARNESS COMBINATION
C-112 (9-GR)	INSTRUMENT PANEL WIRING HARNESS AND FLOOR WIRING HARNESS (RH) COMBINATION		

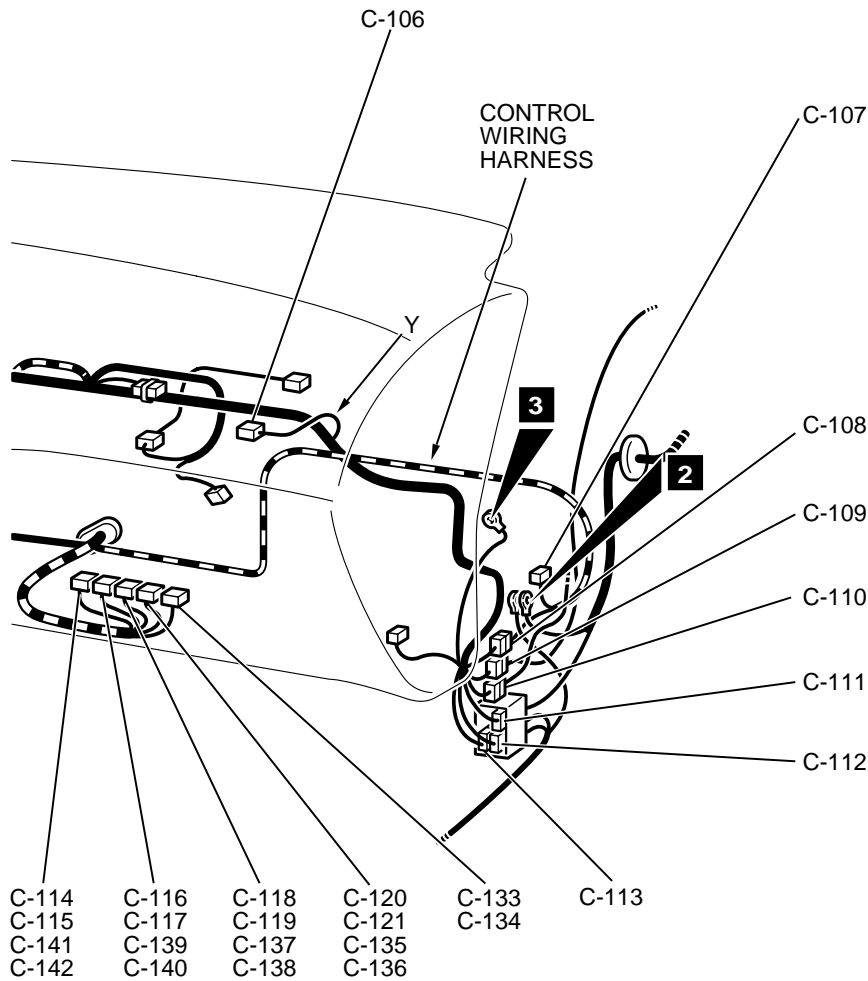

AC306142AC

- C-124 (25) INSTRUMENT PANEL WIRING HARNESS AND CONTROL WIRING HARNESS COMBINATION
- C-125 (6) BLOWER SWITCH
- C-126 (3) FRONT WIRING HARNESS (LH) AND INSTRUMENT PANEL WIRING HARNESS COMBINATION
- C-127 (13) INSTRUMENT PANEL WIRING HARNESS AND FLOOR WIRING HARNESS (LH) COMBINATION
- C-128 (11-B *²) INSTRUMENT PANEL WIRING HARNESS AND FLOOR WIRING HARNESS (LH) COMBINATION
- C-129 (25) FRONT WIRING HARNESS (LH) AND INSTRUMENT PANEL WIRING HARNESS COMBINATION
- C-130 (2) CLUTCH PEDAL POSITION SWITCH <AUTO-CRUISE CONTROL SYSTEM (M/T) >
- C-131 (2) INTERLOCK SWITCH <M/T>
- C-132 (11-B) REMOTE CONTROLLED MIRROR SWITCH
- C-133 (27-GR) ENGINE CONTROL MODULE <2.4L ENGINE-M/T>
- C-134 (27-GR) POWERTRAIN CONTROL MODULE <2.4L ENGINE-A/T>

- C-135 (28-GR) ENGINE CONTROL MODULE <2.4L ENGINE-M/T>
- C-136 (28-GR) POWERTRAIN CONTROL MODULE <2.4L ENGINE-A/T>
- C-137 (29-GR) ENGINE CONTROL MODULE <2.4L ENGINE-M/T>
- C-138 (29-GR) POWERTRAIN CONTROL MODULE <2.4L ENGINE-A/T>
- C-139 (30-GR) ENGINE CONTROL MODULE <2.4L ENGINE-M/T>
- C-140 (30-GR) POWERTRAIN CONTROL MODULE <2.4L ENGINE-A/T>
- C-141 (26-GR) ENGINE CONTROL MODULE <2.4L ENGINE-M/T>
- C-142 (26-GR) POWERTRAIN CONTROL MODULE <2.4L ENGINE-A/T>

NOTE:

1. ON 2.4L ENGINE ONLY, THE STANDARD MOUNTING POSITION OF WIRING HARNESS IS MARKED BY *¹.
2. THE CONNECTOR COLOR MARKED BY *² IS FOR THE FEMALE SIDE. FOR THE MALE SIDE, THE COLOR IS GRAY.

DASH PANEL (CONTINUED)

Connector
symbol**C** -201
thru
-229

STEERING COLUMN

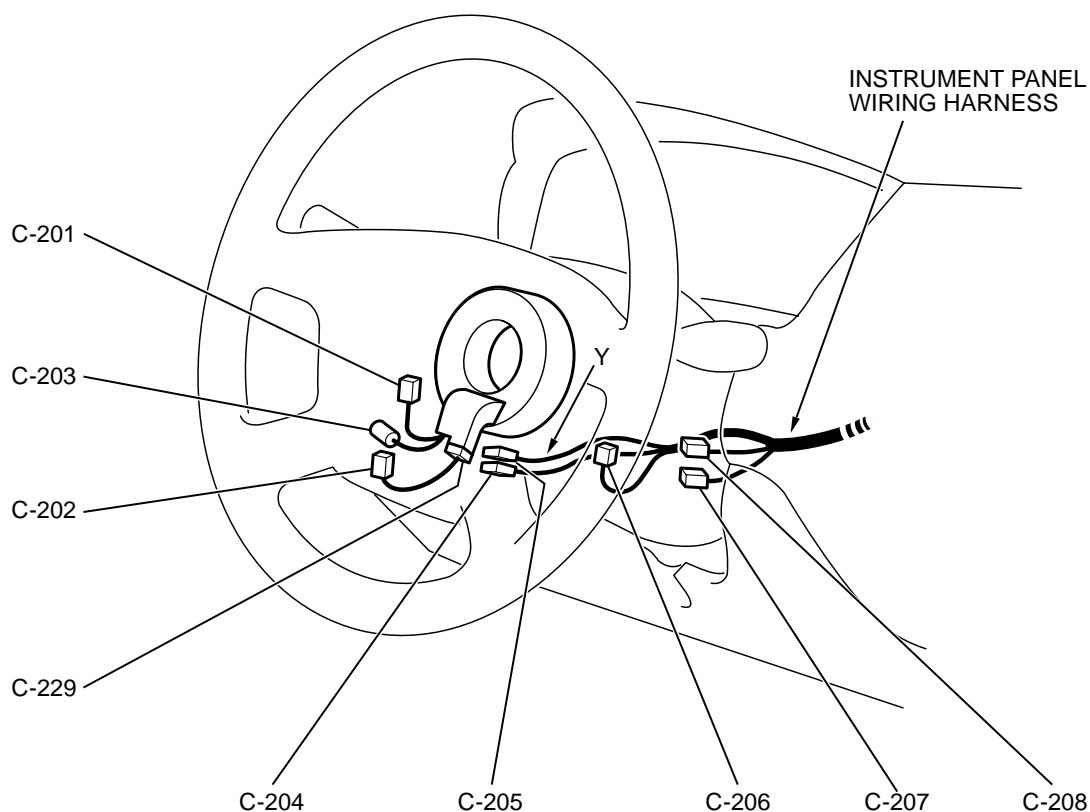

AC107135AB

C-201 (2)	AIR BAG MODULE (SQUIB) <DRIVER'S SIDE>
C-202 (3-Y)	AUTO-CRUISE CONTROL SWITCH
C-203 (1)	HORN SWITCH
C-204 (6)	CLOCK SPRING
C-205 (4-Y)	CLOCK SPRING
C-206 (10)	COLUMN SWITCH
C-207 (7)	KEY REMINDER SWITCH
C-208 (6)	IGNITION SWITCH
C-209 (13)	NO CONNECTION
C-210 (14)	INSTRUMENT PANEL WIRING HARNESS AND JUNCTION BLOCK COMBINATION

C-211 (6)	INSTRUMENT PANEL WIRING HARNESS AND JUNCTION BLOCK COMBINATION
C-212 (1-B)	INSTRUMENT PANEL WIRING HARNESS AND JUNCTION BLOCK COMBINATION
C-213 (5)	ABS WARNING LIGHT RELAY
C-214 (28)	INSTRUMENT PANEL WIRING HARNESS AND JUNCTION BLOCK COMBINATION

JUNCTION BLOCK

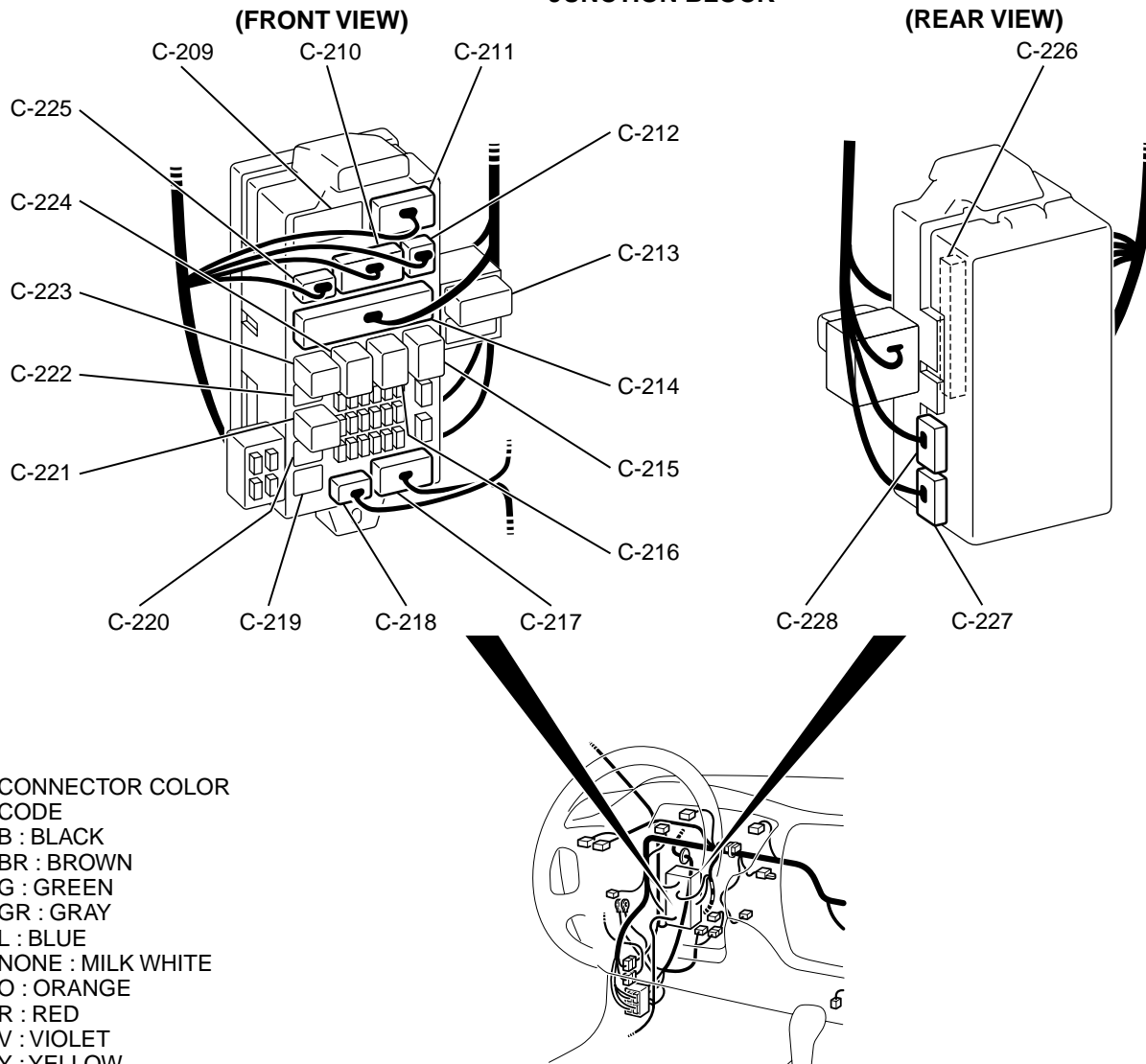

AC307025AB

C-215 (5)	REAR WINDOW DEFOGGER RELAY
C-216 (5)	BLOWER RELAY
C-217 (15)	FLOOR WIRING HARNESS (LH) AND JUNCTION BLOCK COMBINATION
C-218 (3)	ROOF WIRING HARNESS AND JUNCTION BLOCK COMBINATION
C-219 (4)	NO CONNECTION
C-220 (4)	NO CONNECTION
C-221 (4)	FUEL PUMP RELAY (2)
C-222 (4)	NO CONNECTION
C-223 (4)	FUEL PUMP RELAY (1)

C-224 (5)	POWER WINDOW RELAY
C-225 (2)	INSTRUMENT PANEL WIRING HARNESS AND JUNCTION BLOCK COMBINATION <VEHICLES WITH SUNROOF>
C-226 (20)	ETACS-ECU
C-227 (24)	ETACS-ECU
C-228 (24-GR)	ETACS-ECU
C-229 (5)	CLOCK SPRING AND CLOCK SPRING SUB WIRING HARNESS COMBINATION <AUTO-CRUISE CONTROL SYSTEM>

FLOOR AND ROOF

M1801000900628

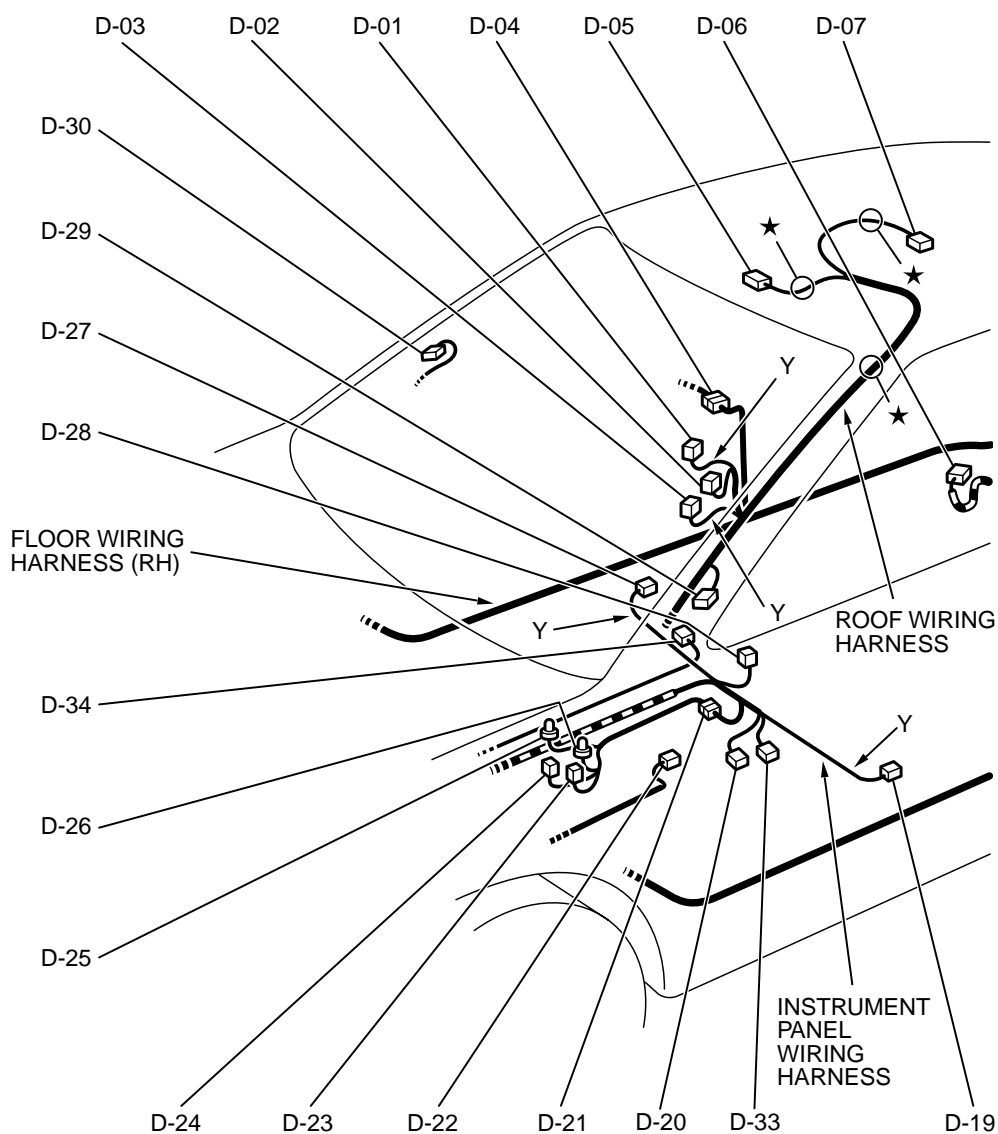
Connector
symbol**D**

AC306139AB

D-01	(3)	DOOR SWITCH (FRONT: RH)	D-10	(3-B)	FUEL LEVEL SENSOR
D-02	(2)	SIDE IMPACT SENSOR (RH)	D-11	(3)	DOOR SWITCH (REAR: LH)
D-03	(2-B)	SEAT BELT PRETENSIONER (RH)	D-12	(5-GR)	FUEL PUMP MODULE
D-04	(8)	FLOOR WIRING HARNESS (RH) AND REAR DOOR WIRING HARNESS (RH) COMBINATION	D-13	(2-B)	WHEEL SPEED SENSOR (REAR: LH) <ABS>
D-05	(2)	FRONT DOME LIGHT	D-14	(13)	FLOOR WIRING HARNESS (LH) AND FUEL WIRING HARNESS COMBINATION
D-06	(2-B)	WHEEL SPEED SENSOR (REAR: RH) <ABS>	D-15	(8)	FLOOR WIRING HARNESS (LH) AND REAR DOOR WIRING HARNESS (LH) COMBINATION
D-07	(2-GR)	REAR DOME LIGHT			
D-08	(3)	DOOR SWITCH (REAR: RH)			
D-09	(3-B)	FUEL TANK DIFFERENTIAL PRESSURE SENSOR			

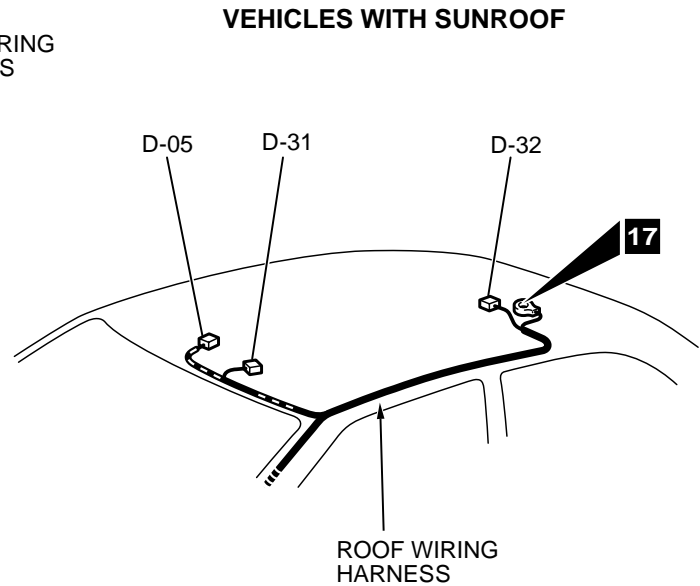
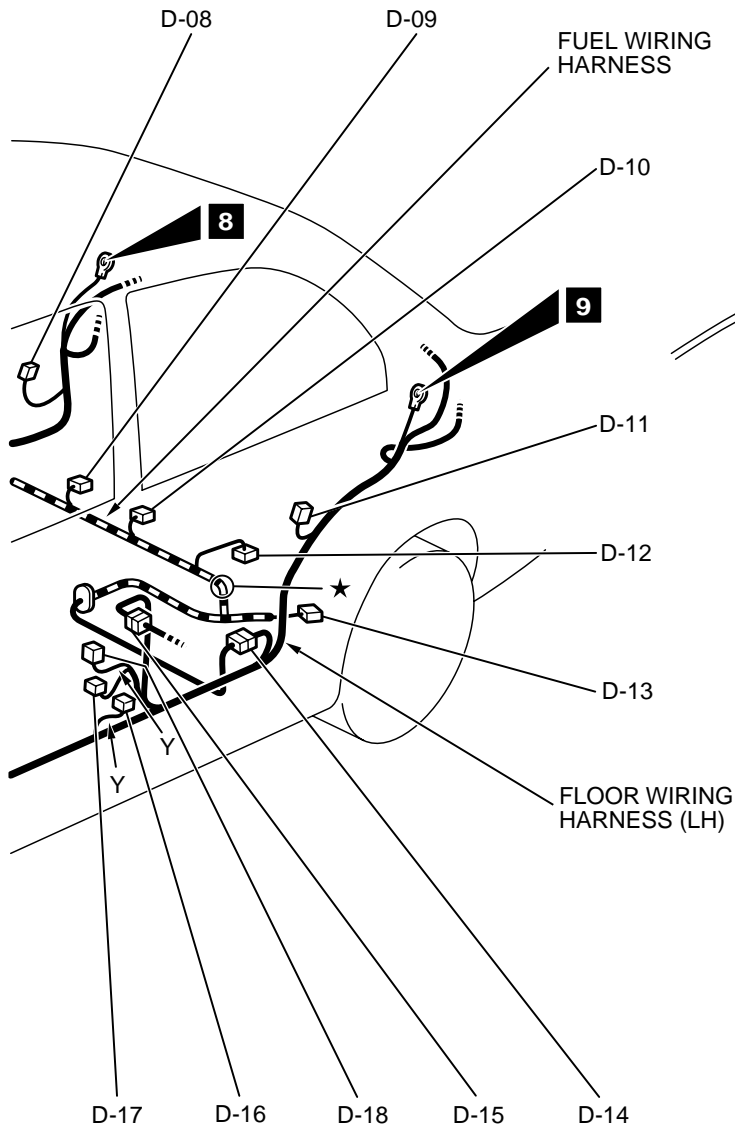

CONNECTOR COLOR
CODE
B : BLACK
BR : BROWN
G : GREEN
GR : GRAY
L : BLUE
NONE : MILK WHITE
O : ORANGE
R : RED
V : VIOLET
Y : YELLOW

AC307045AB

D-16	(2-B)	SEAT BELT PRETENSIONER (LH)
D-17	(2)	SIDE IMPACT SENSOR (LH)
D-18	(3)	DOOR SWITCH (FRONT: LH)
D-19	(2-R)	SIDE AIR BAG MODULE (SQUIB) (LH)
D-20	(2)	SEAT BELT SWITCH
D-21	(4)	INSTRUMENT PANEL WIRING HARNESS AND CONSOLE WIRING HARNESS COMBINATION
D-22	(2)	A/T SELECTOR LEVER POSITION ILLUMINATION LIGHT
D-23	(1)	CIGARETTE LIGHTER
D-24	(1-B)	CIGARETTE LIGHTER

D-25	(2-B)	ASHTRAY ILLUMINATION LIGHT
D-26	(2-B)	CIGARETTE LIGHTER ILLUMINATION LIGHT
D-27	(2-R)	SIDE AIR BAG MODULE (SQUIB) (RH)
D-28	(1-B)	PARKING BRAKE SWITCH
D-29	(2)	TWEETER (LH)
D-30	(2)	TWEETER (RH)
D-31	(6-B)	SUNROOF SWITCH
D-32	(10)	SUNROOF MOTOR ASSEMBLY
D-33	(18)	AUDIO AMPLIFIER
D-34	(4)	HEATED OXYGEN SENSOR (REAR) <2.4L ENGINE>

DOOR

Connector
symbol**E**

DRIVER'S SIDE

FRONT

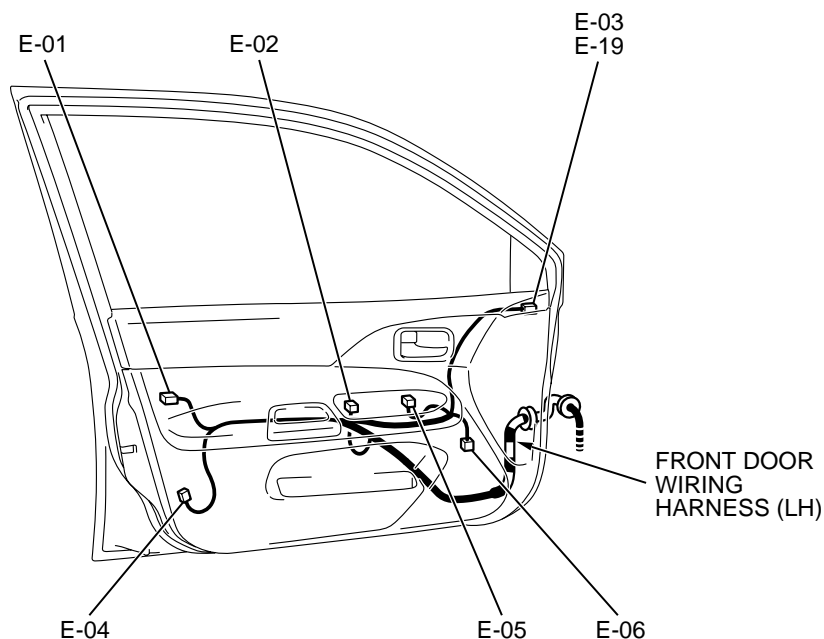

REAR

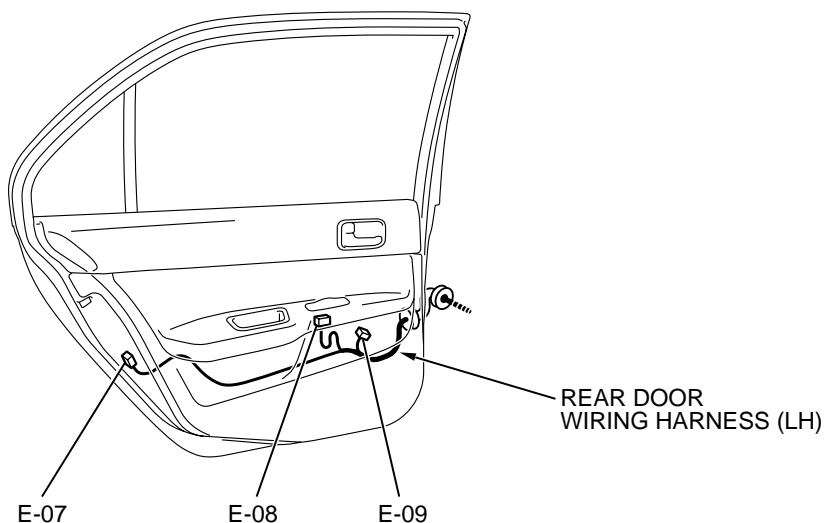

AC305514AB

E-01	(3-B)	DOOR LOCK KEY CYLINDER SWITCH (LH)	E-06	(2)	DOOR SPEAKER (LH)
E-02	(6-GR)	POWER WINDOW MOTOR (FRONT: LH)	E-07	(6-B)	DOOR LOCK ACTUATOR (REAR: LH)
E-03	(3)	REMOTE CONTROLLED MIRROR (LH) <VEHICLES WITHOUT DOOR MIRROR HEATER>	E-08	(8)	POWER WINDOW SUB SWITCH (REAR: LH)
E-04	(6-B)	DOOR LOCK ACTUATOR (FRONT: LH)	E-09	(6-GR)	POWER WINDOW MOTOR (REAR: LH)
E-05	(14)	POWER WINDOW MAIN SWITCH	E-10	(3)	REMOTE CONTROLLED MIRROR (RH) <VEHICLES WITHOUT DOOR MIRROR HEATER>

PASSENGER'S SIDE

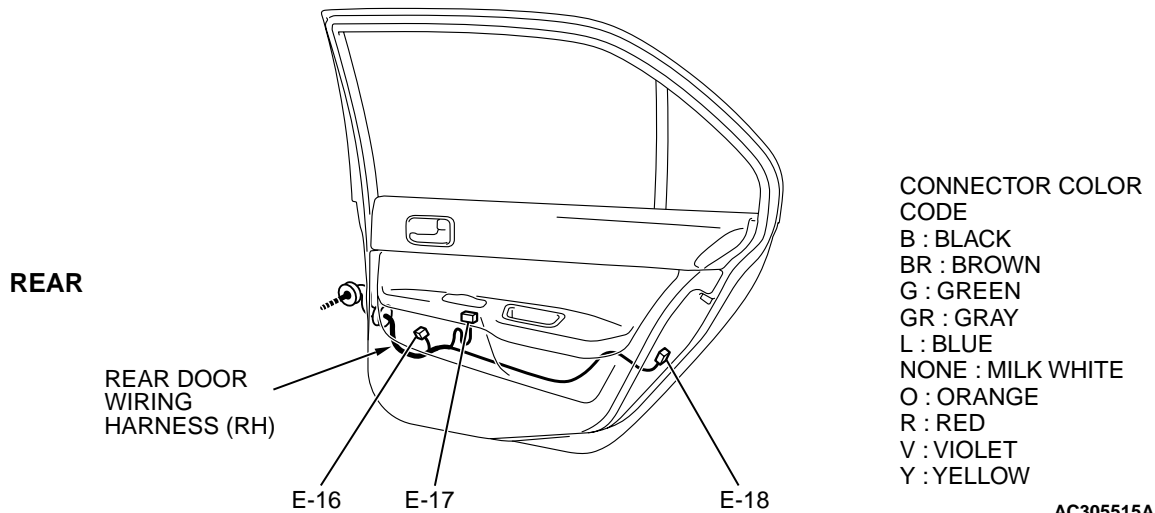
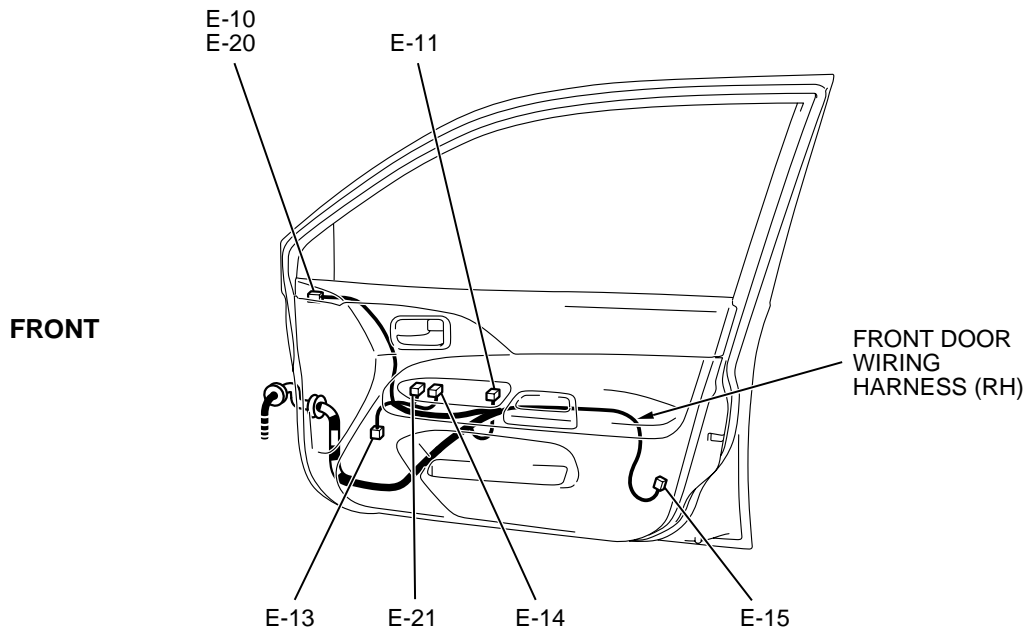

AC305515AB

E-11	(6-GR)	POWER WINDOW MOTOR (FRONT: RH)	E-18	(6-B)	DOOR LOCK ACTUATOR (REAR: RH)
E-13	(2)	DOOR SPEAKER (RH)	E-19	(7)	REMOTE CONTROLLED MIRROR (LH) <VEHICLES WITH DOOR MIRROR HEATER>
E-14	(8)	POWER WINDOW SUB SWITCH (FRONT: RH)	E-20	(7)	REMOTE CONTROLLED MIRROR (RH) <VEHICLES WITH DOOR MIRROR HEATER>
E-15	(6-B)	DOOR LOCK ACTUATOR (FRONT: RH)	E-21	(4)	POWER WINDOW SUB SWITCH <DOOR LOCK SWITCH (FRONT: RH)>
E-16	(6-GR)	POWER WINDOW MOTOR (REAR: RH)			
E-17	(8)	POWER WINDOW SUB SWITCH (REAR: RH)			

LUGGAGE COMPARTMENT

M1801001500377

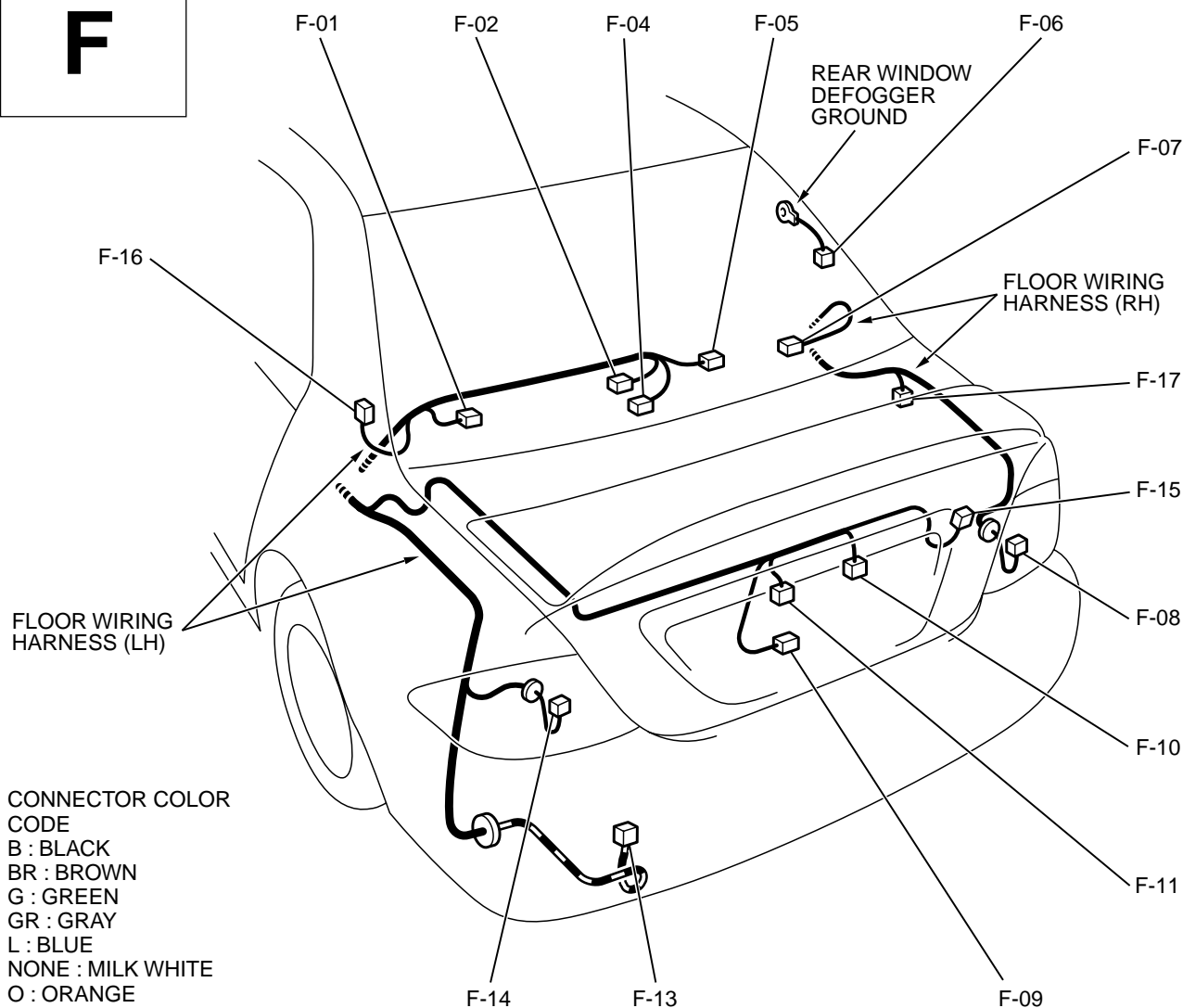
Connector
symbol**F**CONNECTOR COLOR
CODE

B : BLACK
 BR : BROWN
 G : GREEN
 GR : GRAY
 L : BLUE
 NONE : MILK WHITE
 O : ORANGE
 R : RED
 V : VIOLET
 Y : YELLOW

AC306155AB

F-01	(2)	REAR SPEAKER (LH)
F-02	(2)	LUGGAGE COMPARTMENT LIGHT
F-04	(2-B)	HIGH-MOUNTED STOPLIGHT <REAR SHELF>
F-05	(4)	REAR WIPER MOTOR
F-06	(1-B)	REAR WINDOW DEFOGGER (-)
F-07	(2)	REAR SPEAKER (RH)
F-08	(6-B)	REAR COMBINATION LIGHT ASSEMBLY (RH)
F-09	(1-B)	LUGGAGE COMPARTMENT LIGHT SWITCH

F-10	(2-GR)	LICENSE PLATE LIGHT (RH)
F-11	(2-GR)	LICENSE PLATE LIGHT (LH)
F-13	(2-B)	EVAPORATIVE EMISSION VENTILATION SOLENOID VALVE
F-14	(6-B)	REAR COMBINATION LIGHT ASSEMBLY (LH)
F-15	(2)	HIGH-MOUNTED STOPLIGHT <REAR SPOILER>
F-16	(1)	REAR WINDOW DEFOGGER (+)
F-17	(4-B)	WOOFER